

PLAN SHOWING THE PROPOSED CONSTRUCTION OF RESIDENTIAL GROUND FLOOR BUILDING SITUATED IN SY.NO.1036, PLOT NO.16, BLOCK NO:12, SRIMANARAYANA COLONY,KODADA (MUNCIPALITY), NALGONDA (Dt), TELANGANA.
 BELONGS TO:-
 SRI. THIPIRISHETTI SATYANARAYANA. S/O VEERAJAH

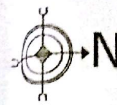

	SPECIFICATION
FOUNDATION	R.C.C.FOOTING IN 1:2:4 OVER C.C BED IN 1:5:10
BASEMENT	C.R.S MASONRY IN CM 1:6
SUPER STRUCTURE	BRICK MASONRY IN CM 1:6
ROOFING	R.C.C SLAB IN 1:2:4
PLASTERING	IN CM 1:4
FLOORING	MABLE STONES
WOOD WORK	CUNTRY WOOD

REFERECE	
D	DOOR 3'-6" X 7'-0"
W	WINDOW 5'-0" X 5'-0"
V	VENTILATOR 5'-0" X 1'-0"

AREAS	SFT	SYD	SQM
PLOT AREA	1045.98	118.22	97.21
ROAD EFFECTED AREA	100.00	11.11	9.29
NETT AREA	945.98	105.11	87.92
PLINTH AREA			
PROP. G.F	610.50	67.83	56.73
OPEN AREA	335.48	37.28	31.19
COMP WALL	134.50 (R.F.T)		

PROPOSED SHOWN IN RED		
EXISTING SHOWN IN BLUE		
SET BACK	AS FOR G.O	AS FOR SITE
FRONT	1.50 M	1.50 M
REAR	0.00 M	0.00 M
SIDE- L	0.00 M	0.00 M
SIDE- R	0.00 M	1.06 M

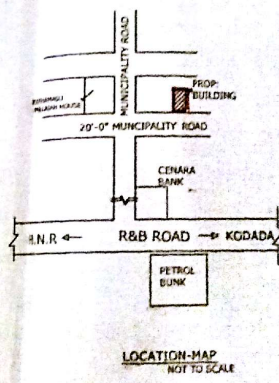

HOUSE OF RAYAPUDI SURESH

HOUSE OF RAYAPUDI SURESH

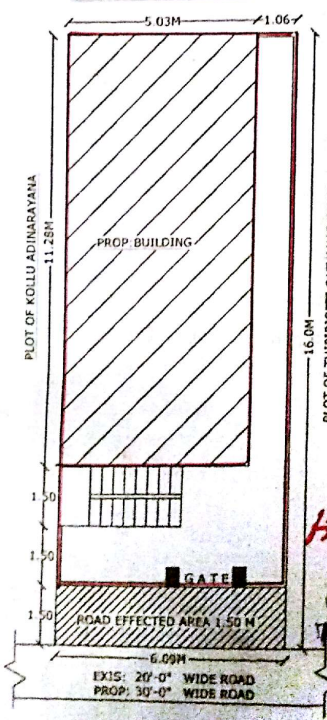
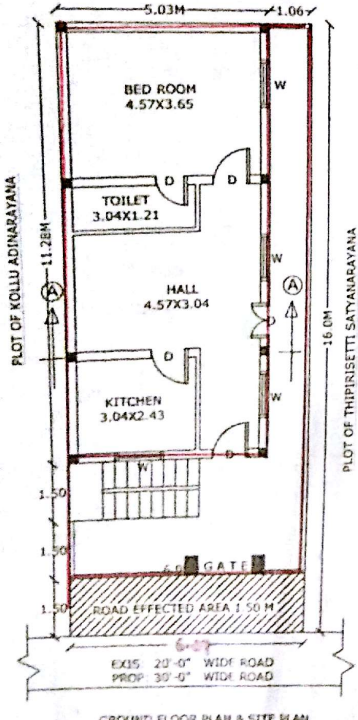

Building No. 2117
 Dated: 13.10.15
 Rs. 45,711/-
 Receipt and this mission is valid upto 12-10-2018
 13/10/2015 TPO

OWNER'S SIGNATURE
 Ch. Nageswar Rao
 Licensed Civil Engineer
 Lic. No. GM591/2014
VASTHU REKHA
 Architects Engineers & Buildings
 Main Road, KODADA-503 204.