

PLAN SHOWING THE PROPOSED CONSTRUCTION OF GROUND AND FIRST FLOOR RESIDENTIAL BUILDING, H NO 3-127, WARD NO: BLOCK NO. 3, SITUATED AT NAGARJUNA HOTEL BACK SIDE ANANTA GIRI ROAD KODAD (TOWN), NALGONDA (DIST), TELANGANA STATE.

BELONGS TO SMT KONDAPALLI MADHAVI LATHA W/O UPENDER



AREAS	SFT	SQ YDS	SQMTS
TOTAL PLOT AREA	1800.00	200.00	167.20
ROAD EFFECTED AREA	896.31	99.59	83.26
NET AREA	903.69	100.41	83.94
PLINTH AREA'S			
PROP GROUND FLOOR	440.19	48.91	40.89
PROP FIRST FLOOR	440.19	48.91	40.89
OPEN AREA	463.41	51.49	43.06
COMPOUND WALL	-	-	38.14 RMTS

SPECIFICATIONS	
FOUNDATION	R C C COLUMNS & BEAMS
BASEMENT	C R S MASONRY IN C M
SUPERSTRUCTURE	BRICK MASONRY IN C M
ROOF	R C C SLAB
PLASTERING	IN C M 1:4
FLOORING	MARBLE
DOORS & WINDOWS	C T & TEAK WOOD

PROPOSED	ALL DIMENSIONS ARE IN MTS
EXISTING	
AFFECTED	SCALE: 1:100

SCHEDULE OF OPENINGS	
DOORS	"D" - 1.00X2.00M
WINDOW	"W" - 1.50X1.25M
VENTILATORS	"V" - 1.50X0.25M

SETBACKS	AS PER GO	AS PER PLAN
FRONT OPEN	3.00 M	3.00 M
SIDE OPEN-1	1.00 M	1.00 M
SIDE OPEN-2	1.00 M	1.00 M
REAR OPEN	1.00 M	1.00 M

CONTRACTOR SIGNATURE
SK ZAMEER
 Licensed Surveyor No: G020701013
 HUDA BUILDERS
 CELL: 99631 77399

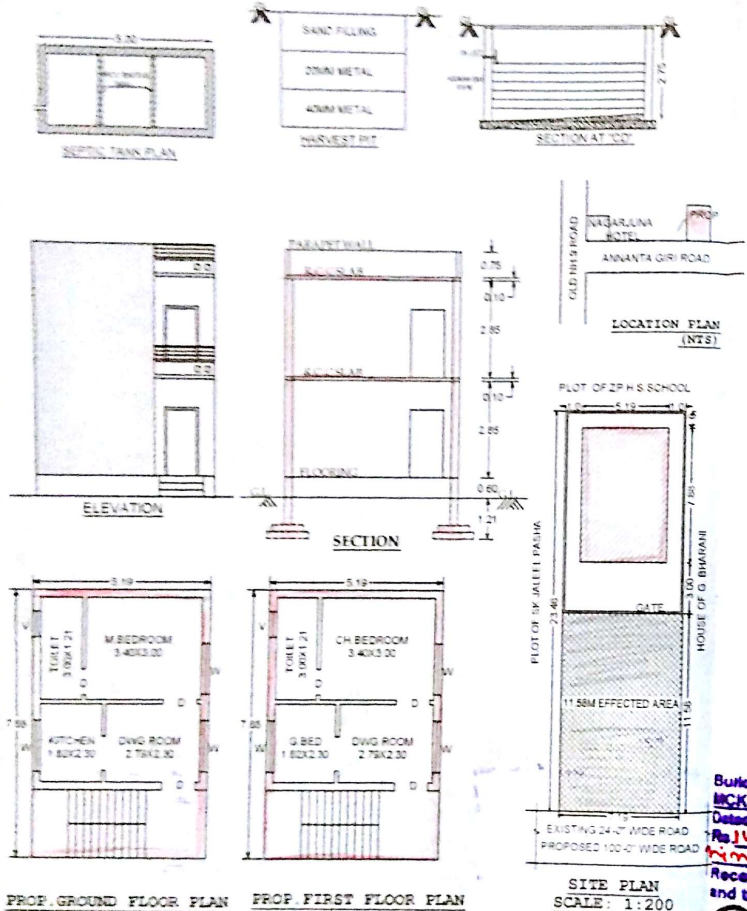

SANCTIONED
 Building permission accorded vide No. **MCK/01/2559** dated **26-11-2015** following an amount of **Rs 14,956** (Rupees **fourteen thousand nine hundred fifty six** only) vide Receipt No. **01/4010383** dated **23-11-2015** and this permission is valid upto **23-11-2018**