

PLAN SHOWING THE PROPOSED CONSTRUCTION OF GROUND & FIRST FLOOR RESIDENTIAL BUILDING IN PLOT NO.12(PART), SY.NO:926/B, SITUATED AT KATTARAMPUR, KARIMNAGAR (TOWN).

BELONGS TO:  
SMT. KETHIREDDY JYOTHI,  
W/O. VISHWA PRAKASH REDDY.  
L.R.S.NO.G2/3346/30/2015/KNR.

SCALE 1:100

**N**

**SPECIFICATIONS**

- \* FOUNDATION : C.C. BED 1;5;10,R.C.C.1;2;4 FOR FOOTING, COLUMNS, PLINTH BEAMS.
- \* SUPERSTRUCTURE: R.C.C. 1;2;4, FOR COLUMNS, BEAMS, SLAB, BRICK MASONRY IN CM 1;6 FOR WALLS.
- \* FLOORING : MARBLE STONE.
- \* DOORS & WINDOWS : T.W. FRAMES WITH SHUTTERS & GLAZING.
- \* SCHEDULE: WINDOWS:  
DOORS : 1.07X1.98 W0: 1.82X1.22  
D: : 1.00X1.98 W: 1.22X1.22  
D1: : 0.76X1.98 W1: 0.76X1.2

**INDEX**

PROPOSED CONSTRUCTION:   
TOTAL PLOT AREA : 168.57 SQ.MTS

**BUILTUP AREAS:**  
GROUND FLOOR : 101.21 sqmts  
FIRST FLOOR : 101.21 sqmts  
TOTAL AREA : 202.42 sqmts

OPEN AREA : 67.36 sqmts

COMP. WALL LENGTH : 52.57 rmts   
ALL DIMENSIONS ARE IN METRES

SIG. OF OWNER

*K. Jyothi*

SIG. OF ENGINEER

*K. Venkateshwar Reddy*  
**K. VENKATESHWAR REDDY**  
Licenced Engineer  
MUNCIPAL CORPORATION  
KARIMNAGAR - 505 001  
Licenced Reg. No.  
G1/1444/2007

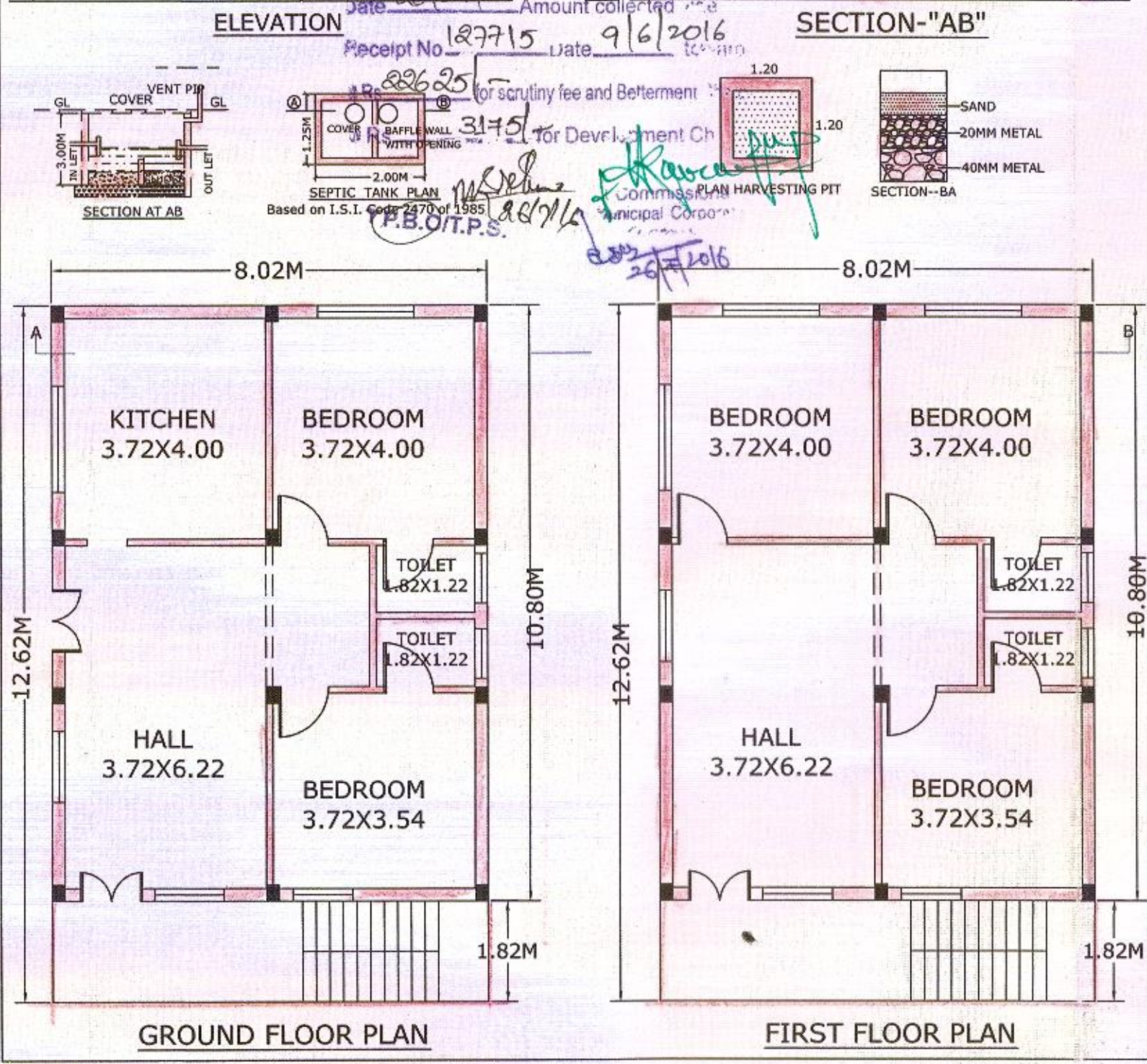
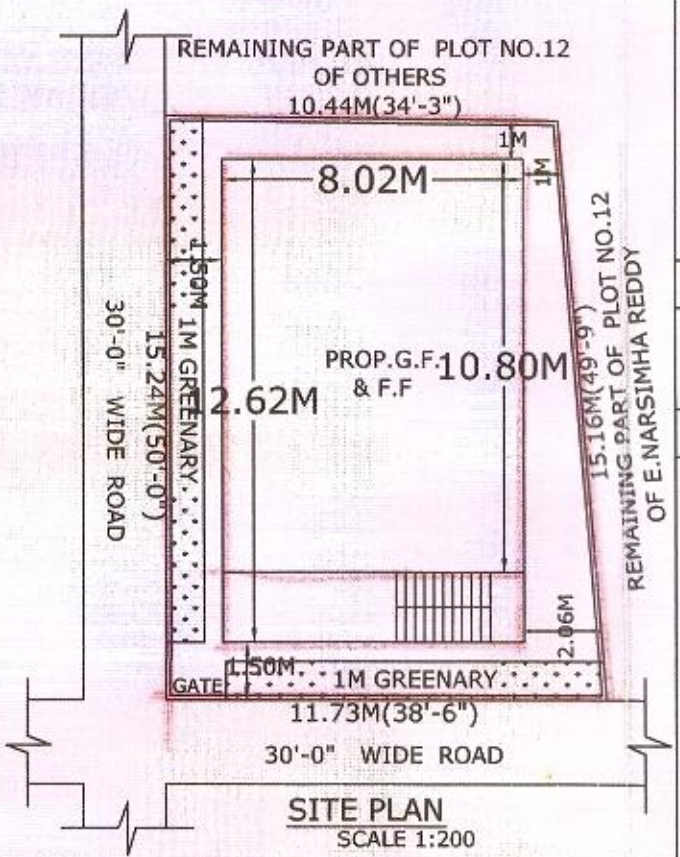
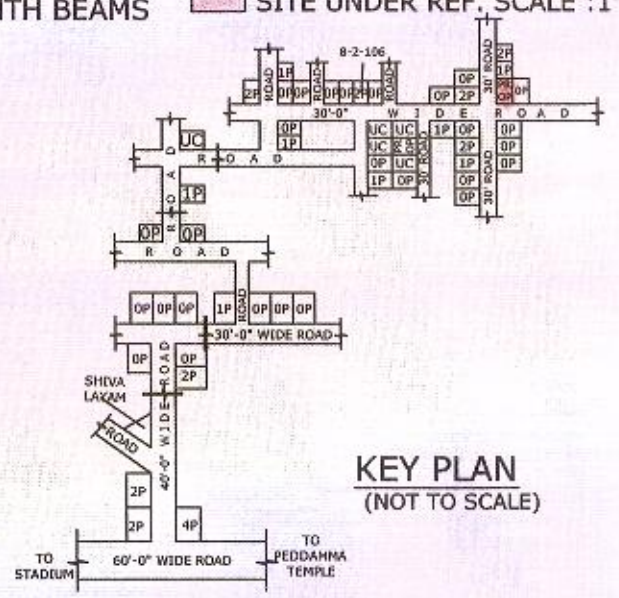
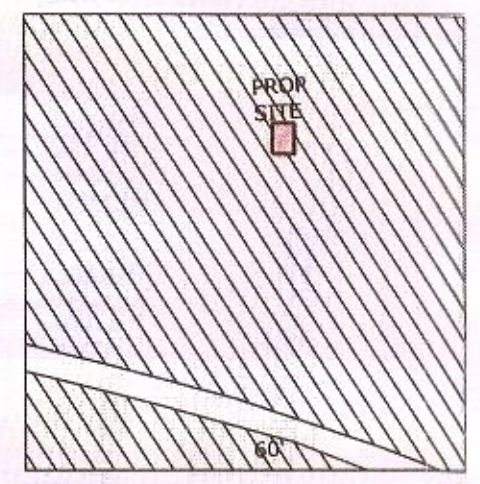

Note: This is only Municipal Sanction for Construction without Prejudice to any body's civil right on the land. This Permission is hereby Sanctioned.

G+1 for Residential/Commercial  
100/111 C.C. NO. 572/2016  
Date: 26/07/2016

Receipt No: 127715 Date: 9/6/2016

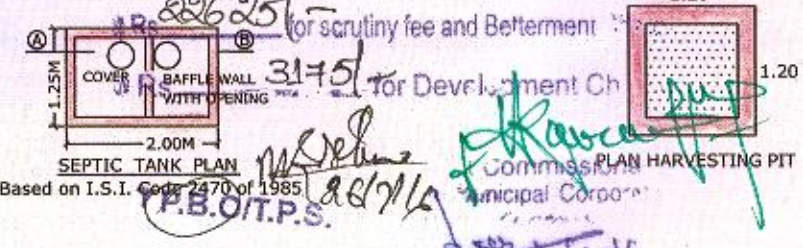

Based on I.S.I. Code 2470 of 1985  
P.B.O/T.P.S.