

EXTRACT OF MASTER PLAN SITUATED AT INDUSTRIAL HOUSING COLONY, LABOUR COLONY, WARANGAL [Dist.], SCALE : 800'-0" FEET AN INCH SITE UNDER REFERENCE

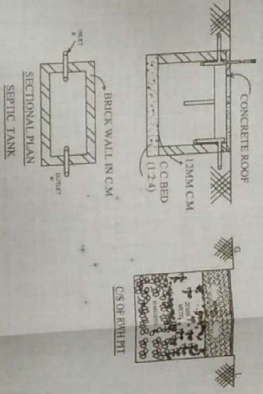

PLAN SHOWING THE PROPOSED CONSTRUCTION OF GROUND FLOOR R.C.C. RESIDENTIAL BUILDING, IN THE EXISTING PREMISES BY REMOVING OLD HOUSE BEARING HOUSE No. 16-12-20 T.R.T. Q.No. 201, SITUATED AT INDUSTRIAL HOUSING COLONY, LABOUR COLONY, WARANGAL [Dist.].

BELONGS TO:
DIDDI NAGAMANI W/O KOMURAJAH

AREA DETAILS:

TOTAL PLOT AREA	: 157.88 Sq. Mts. [or 188.84 Sq. Yds.]
PROP. G/F BUILTUP AREA	: 105.45 Sq. Mts
OPEN AREA	: 52.43 Sq. Mts

SPECIFICATIONS:

FOUNDATION	: U.C.R.S. IN CM
BASEMENT	: C.R.S. IN CM
S. STRUCTURE	: BRICK IN CM
ROOFING	: R.C.C. SLAB
FLOORING	: MARBLES/TILES
PLASTERING	: WITH CM
DOOR & WINDOW	: TEAK WOOD

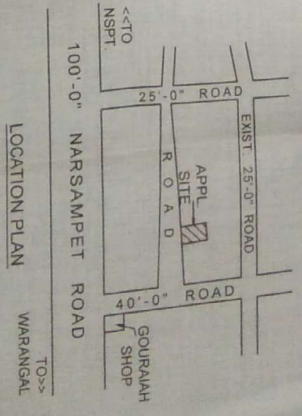
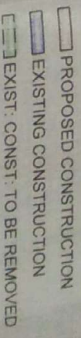

G. SRINIVAS
LICENCED SURVEYOR
Lic. Regd. No. 02/1890
MUNICIPAL CORPORATION
WARANGAL

D. R. S. S. S.
OWNERS SIGN

T.P.B.O.'s SIGN

