

ELEVATION

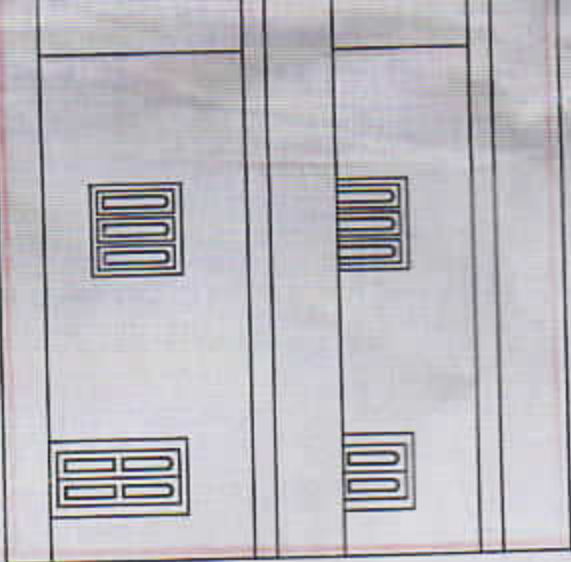

CROSS SECTION AT A-B

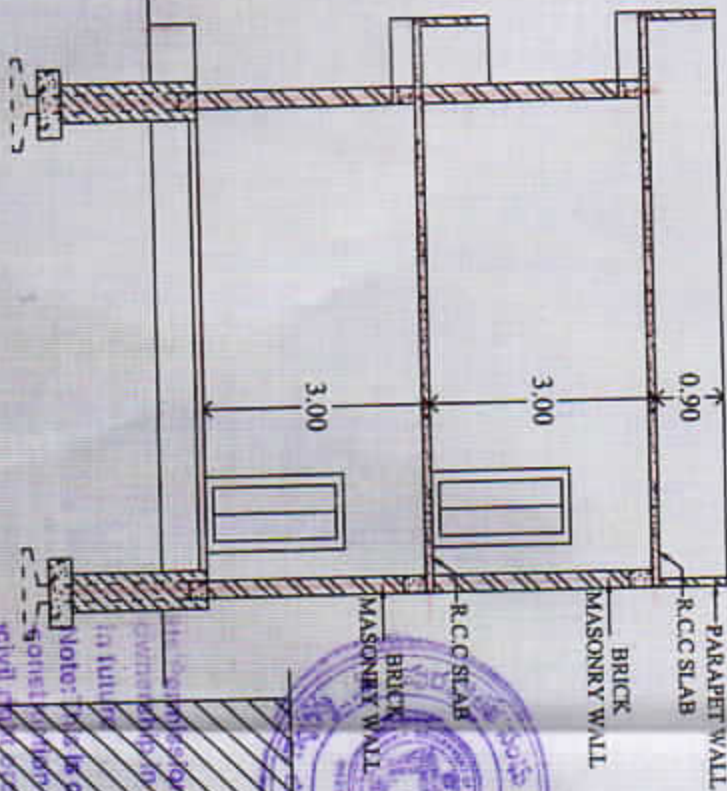

EXTRACT OF MASTER PLAN SIRCIILLA

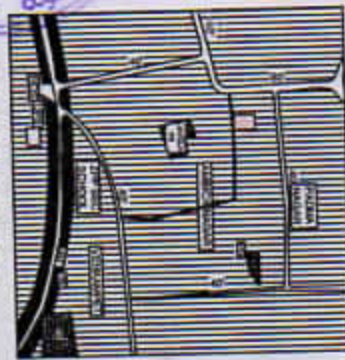

KEY PLAN (NOT TO SCALE)

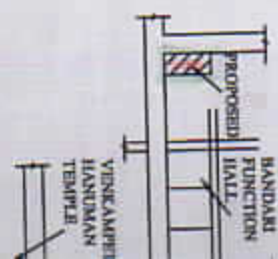

ROAD EFFECTED 2.89 M (9'-6")

EX. 21' ROAD TO BE WIDENED AS 40'

ROAD EFFECTED 2.89M (9'-6")



IN P.L.

Handwritten notes in purple and red ink:

- DA No. 541 dated 25/06/18
- Amount collected vide receipt No. 541/2018
- Development charge
- 22.55
- 22.86
- 14.18
- 7.58
- 13.71
- 7.58
- 14.18
- 22.86