

c) ALL ROUND OPEN SPACES:

(all in mts)

Sides	Direction	Road width (in m)	Set back (in m)			Remarks
			Required	Provided	Shortfall	
Front			1.50	1.50		
Rear						
S(1)						
S(2)						

d) Height of the Building:

Permissible as per the G.O.Ms.No.168, MA, dt: 7.04.2012	Proposed	Remarks
	9m	-

e) Mortgage Area:

Built up Area	Required	Provided	Remarks
52.91	5.3	5.3	-

The Technical data above is satisfying the provisions laid down in the above said G.O Ms No. 168, MA., dt: 07-4-2012 and the building proposals are not in violation of B.R/Z.R

Hence the proposals submitted by the applicant for construction of Commercial /Residential building with Ground floor/First floor/Second floor may be granted.

*may be approved*

*Khejras*  
T.P.O 26/2

*[Signature]*  
T.P.O 26/2

*[Signature]*  
Commissioner

**Technical remarks of TP&BO/TPS/TPO  
Municipal Council Siricilla.**

File No. 1141 / 2  
BA No. 138 / 2015

**DETAILS OF THE PROPOSALS:**

1) The applicant Jupelli Plethvidha Rao 9/10 Vaan submitted the proposals for construction individual residential/ Commercial building Stilt, Ground, First & Second floor in Sy No./H No. 6-6-53 situated at Geelha nagal of Municipal Council Siricilla.

2) **Ownership Document Details:**

In support of ownership title on the site the applicants have furnished copies of the following documents attested by Gazetted Officer, the title deeds have been examined and the details are tabulated below:

SI No	Document No	Status	Vendor	Vendee	Sy No / H No	Extent In Sq mtrs	Schedule of Bo
1	4818/12	Sale deed	R. Janabai & others	J. Plethvidha Rao	6-6-53	91.13	

3) As per the above Documents it is observed that the site under reference is located developed area. Therefore, the application has been taken up for scrutiny as per the rules, regulations and procedure in vogue.

4) **Inspection Report:** Inspected the site and verified the measurements, Schedule of boundaries documents etc. site under reference is located in old developed area. At present, the site is surrounded by

East : 18'-0" wide Road  
 West : 18'-0" wide Road  
 North : H.No: 6-6-548 Raja Balaram  
 South : H.No. 6-6-53 Rapalle Ramaswamy & brother

The Plans submitted have been verified with reference to the ground position (levels, dimension and area of the plot) and as well as the documents, road width, etc. and found correct and applicant has not commenced the construction work.

5) **The following technical report is submitted with reference to the G.O.Ms.No.168 dt. 07.4.2012 and Building Rules relevant other Zoning Regulations.**

a) **Land Use :** As per the sanctioned GO No. 546 MA, Dt:1-12-2003 of Siricilla town the proposed site under reference is covered by Residential

b) **Details of Plot area:**

Total area	Affected area	Net area
91.13	27.0 m	64.13 m





AT "AA"

FLOORING  
R.C.C. SLAB  
BRICK WALL  
FLOORING  
R.C.C. SLAB  
BRICK WALL  
BASE MENT  
G.L.

EXTRACT OF MASTER PLAN

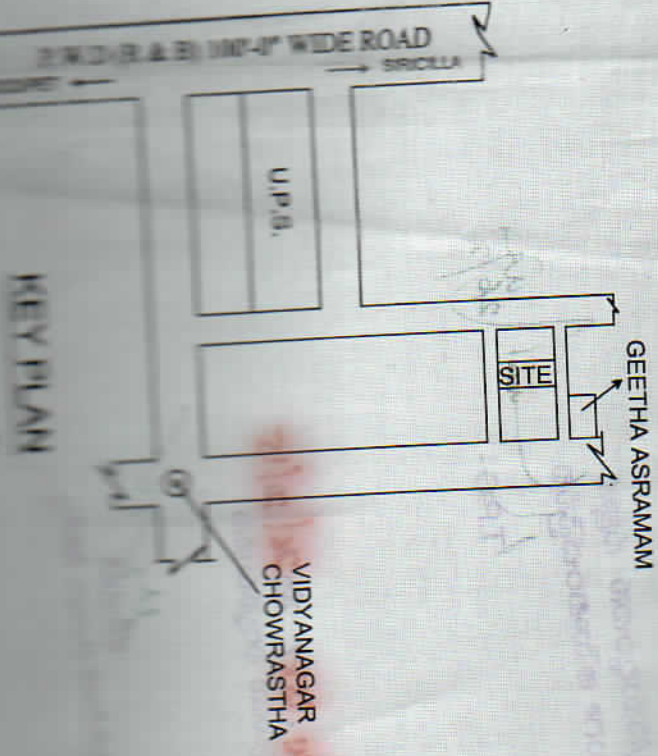

KEY PLAN

BELONGS TO:  
**JUPELLI PRUTHVIDHAR RAO**  
S/o. **VASAVA RAO**  
(The G.Floor & F.Floor R.C.C. Consn. Approved S  
File No. G1/BA/83/68/12., Dated: 09-11-2012. )

**SPECIFICATIONS:**

FOUNDATIONS	C.R.S. MASONRY FOR R.C.C FOOTING FOR
COLUMNS, BEAMS, SLAB, STAIRCASE, ETC.	R.C.C. (1:1.5:3)
SUPERSTRUCTURE	BRICK IN G.M. WITH VITRIFIED TILES.
FLOORING	T.W. FRAMES WITH T.W. FRAMES WITH
DOORS & WINDOWS	AS PER ACT.
VENTILATORS	
ELECTRIFICATION, SANITERY, WATER SUPPLY, ETC.	

**SCHEDULE OF JOINERY:**

DOORS	WINDOWS &
DM : (1.05x2.10m) - 01	W : (1.80
D : (1.00x2.10m) - 01	W1 : (1.50
D1 : (0.90x2.10m) - 01	KW : (1.20
D2 : (0.75x2.10m) - 01	V : (0.75
TOTAL - 04	TOTAL

**AREAS:**

TOTAL PLOT AREA	: 91.13 Smt. or 109.6
ROAD AFFECTED AREA	: 27.00 Smt.
NET AREA	: 64.13 Smt.

**PLINTH AREAS:**

EXTG. GROUND FLOOR BUA.	: 52.91 Smt.
EXTG. FIRST FLOOR BUA.	: 52.91 Smt.
PROP. SECOND FLOOR BUA.	: 38.00 Smt.
TOTAL PROP. BUILT-UP AREA	: 38.00 Smt.
TOTAL MORTGAGE 10% AREA	
IN SECOND FLOOR	: 4.0 Smt.

**PROP. TOTAL BUA.**

: 38.00 Smt.

PROP. TOTAL BUA. : 38.00 Smt.

**REFERENCE:**

14.78 Smt.