

FILE BACKER

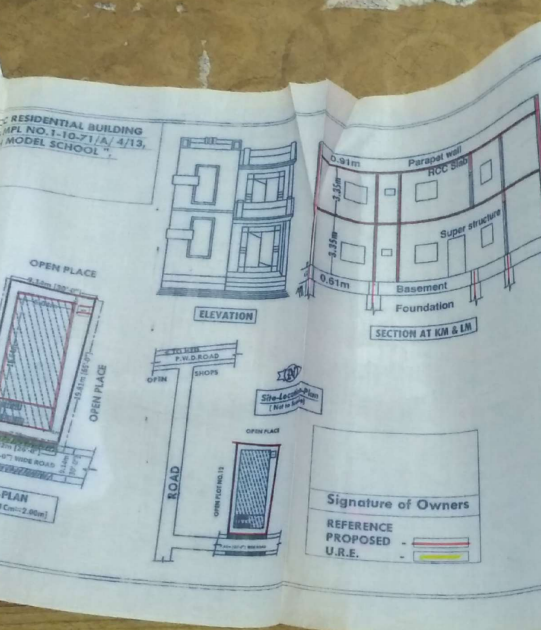

Details Of Area	Sq.Mts
Total Plot Area	171.68
U.R.Effect	6.05
Net Area	165.63
G.F.Plinth (w.c)	100.51
Open Place	65.12
F.F.Plinth (w.c)	100.51
Comp. Wall -	53.00-R.Mts

- SPECIFICATIONS**
- Foundation - CRS in Cm
 - Basement - do
 - Super sl. - Brick in Cm
 - Plastering - Cm
 - Roof - RCC
 - Flooring - Polished St.
 - Doors & wind- C.T.Wood

SCHEDULE OF OPENING

D=Doors	- 1.06x2.05m
D1= "	- 0.91x2.05m
D2= "	- 0.76x2.05m
W=Window	- 1.20 x1.20m
W1= "	- 0.91x1.20m
W2= "	- 0.91x0.76m
W3= "	- 0.76x0.76m

for OFFICE Use

NOTE: This is a Master Plan for the proposed construction. The Building plan is to be approved by the local authority. The plan is to be approved by the local authority. The plan is to be approved by the local authority.

SANCTIONED

The Building plan is to be approved by the local authority. The plan is to be approved by the local authority. The plan is to be approved by the local authority.

EXTRACT-MASTER PLAN UNDER REFERENCE

K.M. Madates,
Architect & Engineers, Medak
Ph.No. 9140848531.

15